

NAME _____ DATE _____
 SCORE _____

Countdown: 5 Weeks

1. Look at the following model. 6 4.NF.6

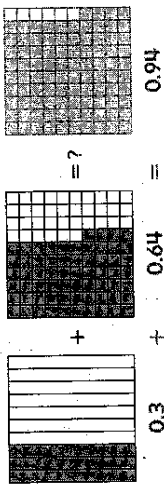

Part A: Write a problem that would require you to use this model to find its solution.

Sample answer: Jory poured $\frac{3}{10}$ of a gallon of water into a bucket. Cory poured 0.64 of a gallon into the same bucket. How many gallons of water were in the bucket?

Part B: Solve the problem you wrote. Include a diagram and labels.

$0.3 + 0.64 = 0.94$

2. Ursula sold 47 copies her new app for \$26 each. How much money did Ursula make? Use the numbers below to fill in the area model. You may not use all of the numbers. 4.NBT.5

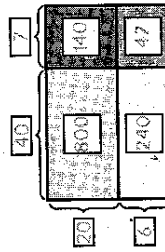

800 36 42 6 20
 400 140 7 24 240

THINK SMART FOR SBAC
 On the actual test, you may drag items to show your answer. In this book, you will use your pencil to write in the items.

3. Ruby has read 0.85 of a book. What fraction of the book does Ruby have left to read? Write your answer in simplest form. 4.NF.5

$\frac{3}{20}$

4. It snowed five times in December with snowfalls of 7 inches, 2 inches, 6 inches, 11 inches, and 5 inches. Use the information below to fill in the table. 4.OA.3

- The smallest snow amount was on December 16.
- The greatest snow amount was on December 30.
- The snow on December 28 was less than the snow on December 14.
- The snow on December 5 was less than the snow on December 28.

| Date | Dec 5 | Dec 14 | Dec 16 | Dec 28 | Dec 30 |
|---------------|-------|--------|--------|--------|--------|
| Snow (inches) | 5 | 7 | 2 | 6 | 11 |

5. Which of the following is equivalent to $\frac{11}{10}$? Select all that apply. 4.NF.5

- 0.25 + 0.15
- $\frac{2}{5}$
- 0.1 + 0.03
- $\frac{12}{100} + 0.28$

44. Grade 4 • Countdown 5 Weeks

Grade 4 • Countdown 5 Weeks 43